

1

2

3

4

A

A

B

B

C

C

D

D

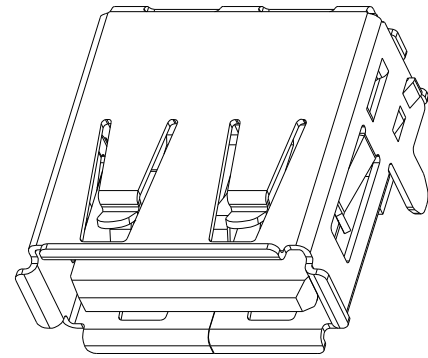
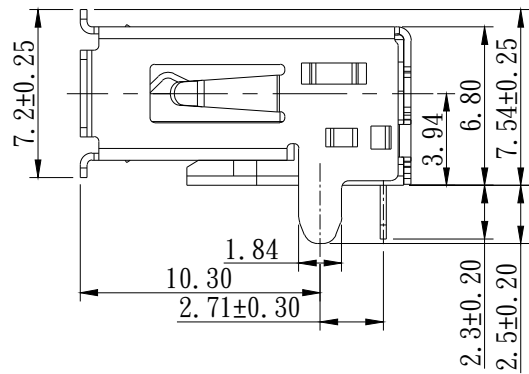
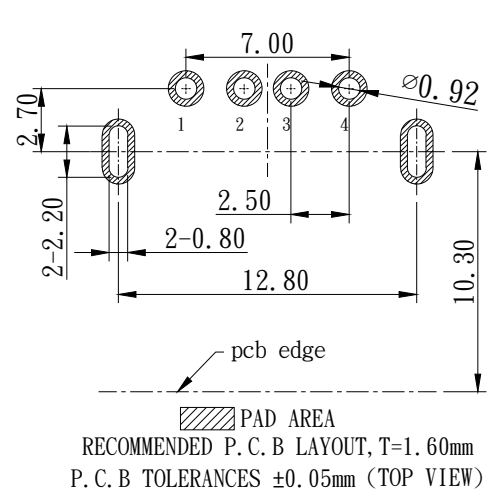
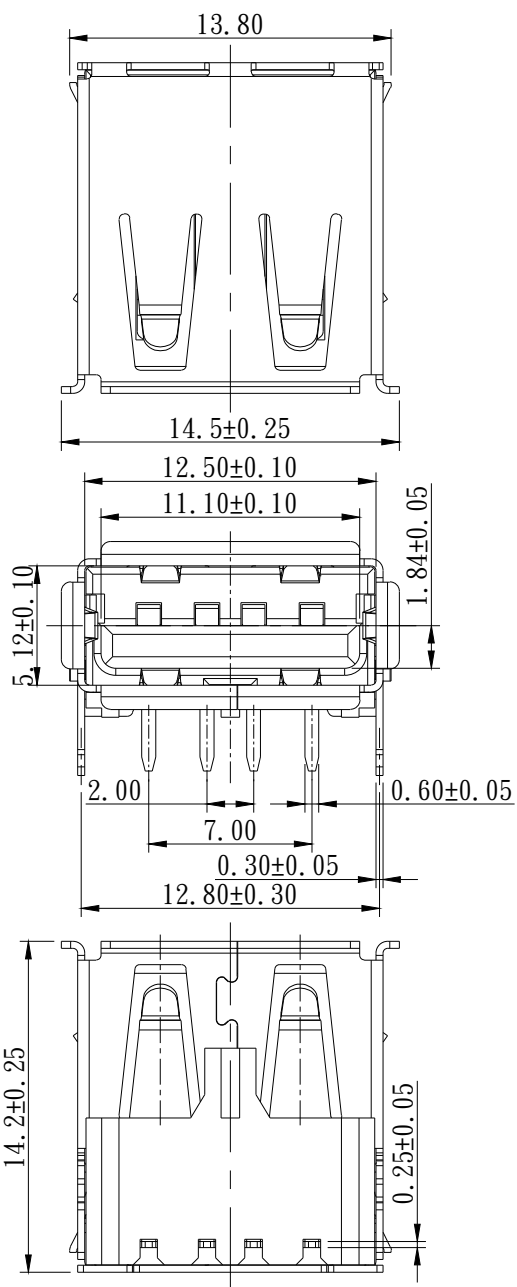

NOTES:

1. MATERIAL:
 - 1.1 HOUSING: LCP, UL94 V-0, COLOR: WHITE
 - 1.2 CONTACT: C2680 (T=0.25mm)
 - 1.3 SHELL: C2680 (T=0.30mm)
2. PLATING:
 - 2.1 CONTACT:
 - NICKEL(30u" MIN) UNDER PLATING OVERALL
 - TIN(80u" MIN) PLATING ON SOLDER AREA
 - AU(30u") PLATING ON CONTACT AREA
 - 2.2 SHELL:
 - NICKEL(50u" MIN) PLATING OVERALL
3. SPECIFICATION:
 - 3.1 CURRENT RATING: 1.5 A
 - 3.2 DIELECTRIC WITHSTANDING VOLTAGE: AC 500V MIN.
 - 3.3 INSULATION RESISTANCE: 1000MΩ MIN
 - 3.4 CONTACT RESISTANCE: 30mΩ MAX
4. MECHANICAL CHARACTERISTICS:
 - 4.1 INSERTION FORCE: 35N MAX
 - 4.2 WITHDRAWAL FORCE: 10N
 - 4.3 DURABILITY: 1500 CYCLES

PART:

10 1 - 1 B W - 7 B1 - L
 10 : USB 2.0 FEMALE
 1 : FOR SINGLE

 1 : FOR 90° DIP
 B : FOR COPPER ALLOY
 W : FOR WHITE

 7 : FOR 30U"
 B1 : SERIES NO.

 L : FOR LEAD FREE

廷奕科技股份有限公司
 VITETECH CO., LTD

REV.	ECN. NO.	APP.	DATE
A	Official Publish	OW	MAY/25/11
B	Official Publish	Sonia	APR/28/20

RoHS COMPLIANT			
DIMENSION CLASSIFICATION			
Ⓞ : CRITICAL		Ⓜ : MAJOR () : REFERENCE	
REVISED	A	APPROVE	DATE
DRAW	CHK'D	JACK	ALAN
OW	JACK	ALAN	MAY/25/11

PRODUCT CUSTOMER COPY	
SCALE	SHEET
1:1	
GENERAL TOLERANCE	
X. ±0.50	.X ±0.40
.XX ±0.35	.XXX ±0.05
X.'	.X'

PART NO:	101-1BW-7B1-L
DWG NAME:	USB2.0 AF 90 7.0H PIP

1

2

3

4